

CINCINNATI

Tri-County Mall
11700 Princeton Pike
Suite E-207
Cincinnati, OH 45246
Tel: 513.671.2862 Fax: 513.671.2868

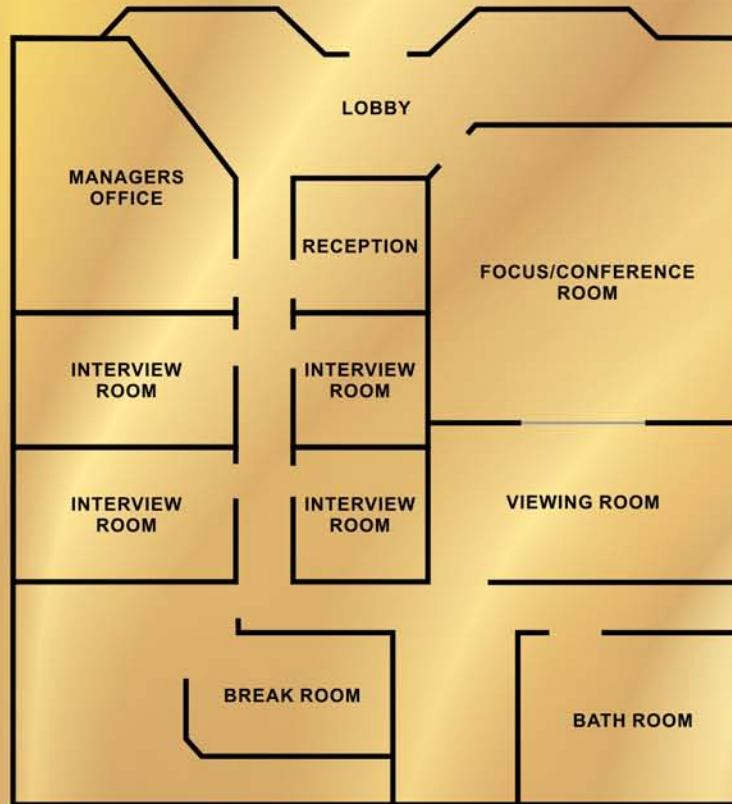

CRG GLOBAL, INC.

www.crgglobalinc.com



Hotel Recommendations

Cincinnati Marriott North: 513.874.7335
Courtyard Cincinnati: 513.733.4334
Hilton Garden Inn: 513.772.2837

Area Restaurants

Montgomery Inn: 513.791.3482
Jean-Roberts at Pigalls: 513.621.1465

Demographics

Average Age: 36
Average Income: \$53,040
Ethnic Mix:
% Caucasian 49
% African American 45
% Hispanic 3
% Other 3

Anchor Stores

Sears, Dillard's, Macy's, Krazy City

Minimum PC Setup

2.4 Ghz, 256 MB RAM,
40 GB HD, Intel Extreme Graphics

In-Depth Interviewing

Executive/Professional
Medical

Facility Description

Interview Rooms: 4
Size: 11x18
Focus Room Seats: 10
Size: 11x9
Viewing Room Seats: 6

Test Kitchen Equipment

Refrigerators 2
Microwaves 2
Freezers 1
Double Ovens 0
Range Top Ovens 0
Toaster Ovens 5

Interviewing Stations: 16

Services Offered

Mall Intercept CAPI / Web
In-Store / Audits Pre-Recruits
Offsite CLT Interviewing
Panel Recruitment

Recruiting Via

Online Automated Recruitment
(Recruiting can be done on site or centrally at corporate using services of Powerdial, CRG's 30 seat telephone center.)

Directions:

From Cincinnati-Northern Kentucky Airport :: Distance: 31 Miles :: Travel Time: 36 Minutes

Take KY-212 North to I-275 East. Take exit 84 to I-75 North. Then take 16 toward I-275 West. Merge onto OH-747 South at exit 42A.

End at 11700 Princeton