

FT. LAUDERDALE/MIAMI

Pembroke Lakes Mall
11401 Pines Boulevard
Suite 702

Pembroke Pines, FL 33026

Tel: 954.438.9315 Fax: 954.438.9367

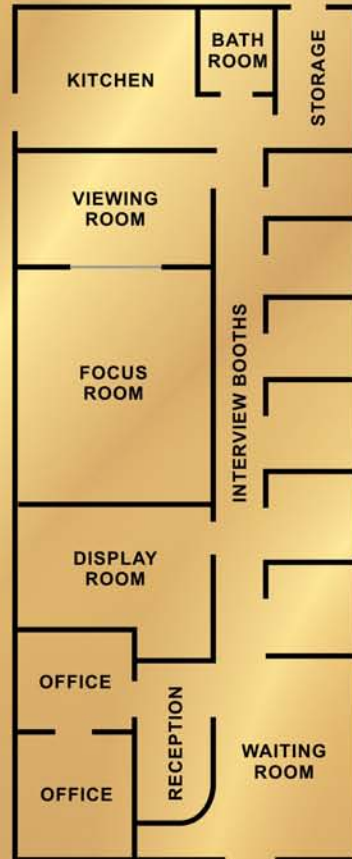

CRG GLOBAL, INC.

www.crgglobalinc.com



Hotel Recommendations

Fairmount Turnberry Isle: 305.932.6200
Wyndham Ft. Lauderdale: 954.920.3300

Area Restaurants

Shula's Steak House: 305.820.8102
Bonefish Grill: 954.389.9273

Demographics

Average Age:	40
Average Income:	\$60,923
Ethnic Mix:	
% Caucasian	73
% African American	16
% Hispanic	7
% Other	4

Anchor Stores

JCPenny, Sears, Dillard's, Macy's

Minimum PC Setup

2.4 Ghz, 256 MB RAM,
40 GB HD, Intel Extreme Graphics

In-Depth Interviewing

Executive/Professional
Medical

Facility Description

Interview Rooms:	6
Focus Room Seats:	12
Size: 13x18	
Viewing Room Seats:	4
Size: 13x9	

Test Kitchen Equipment

Refrigerators	1
Microwaves	2
Freezers	1
Double Ovens	0
Range Top Ovens	0
Electric Burners	4

Interviewing Stations: 6

Services Offered

Mall Intercept CAPI / Web
In-Store / Audits Pre-Recruits
Offsite CLT Interviewing
Panel Recruitment

Recruiting Via

Online Automated Recruitment
(Recruiting can be done on site or centrally at corporate using services of Powerdial, CRG's 30 seat telephone center.)

Directions:

From Ft. Lauderdale Airport :: Distance: 16 Miles :: Travel Time: 26 Minutes
Take 818-W to 441-S. Turn right onto Stirling Rd. (848-W). Turn Left onto N. University Dr. (817-S). Turn right onto Pines Blvd. (820-W), then make a u-turn and go back on 820-E. Enter the mall next to Burdines. We are located in that corridor.

Directions:

From Miami Intl. Airport :: Distance: 24 Miles :: Travel Time: 29 Minutes
Go West on NW 20th St. toward Perimeter Rd. Turn Left onto NW 14th St. Turn Right onto NW 45th Ave. Merge onto 836-W. Merge onto 826-N toward NW 36th St. Merge onto I-75 N toward Naples. Merge onto Pines Blvd. at exit 9A.