

# NASHVILLE

Cool Springs Galleria  
1800 Galleria Boulevard  
Suite 1320  
Franklin, TN 37064  
Tel: 615.771.0442 Fax: 615.771.0447

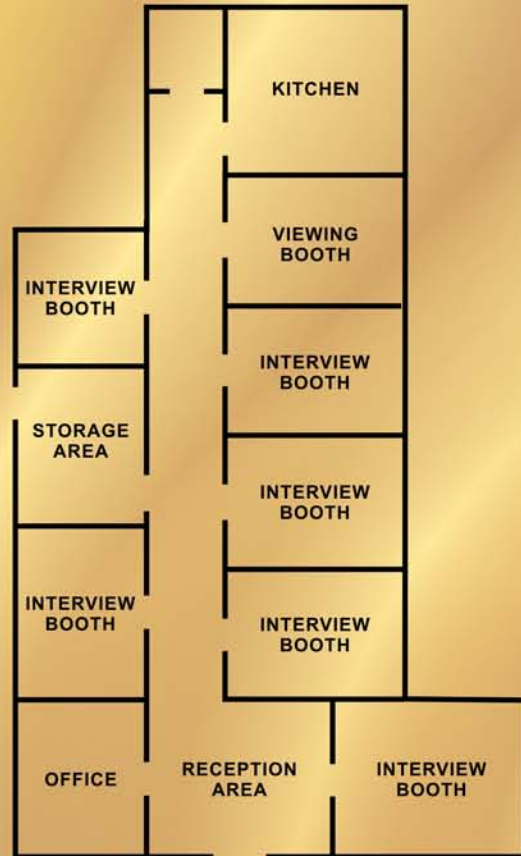

CRG GLOBAL, INC.  
www.crgglobalinc.com



## Hotel Recommendations

Marriott Cool Springs: 615.261.6100  
Hampton Inn: 615.771.7225

## Area Restaurants

Stoney River Steaks: 615.778.0230  
Amerigo's Italian: 615.377.7070

## Demographics

Average Age:	39
Average Income:	\$50,000
Ethnic Mix:	
% Caucasian	84
% African American	14
% Hispanic	0
% Other	2

## Anchor Stores

JCPenny, Sears, Dillard's, Macy's,  
Belk

## Minimum PC Setup

2.4 Ghz, 256 MB RAM,  
40 GB HD, Intel Extreme Graphics

## In-Depth Interviewing

Executive/Professional  
Medical

## Facility Description

Interview Rooms:	7
Size: 11x18	
Focus Room Seats:	10
Size: 11x10	
Viewing Room Seats:	6

## Test Kitchen Equipment

Refrigerators	1
Microwaves	2
Freezers	1
Double Ovens	0
Range Top Ovens	1
Electric Burners	4

**Interviewing Stations:** 6

## Services Offered

Mall Intercept CAPI / Web  
In-Store / Audits Pre-Recruits  
Offsite CLT Interviewing  
Panel Recruitment

## Recruiting Via

Online Automated Recruitment  
(Recruiting can be done on site or centrally at corporate using services of Powerdial, CRG's 30 seat telephone center.)

## Directions:

**From Nashville International Airport :: Distance: 20 Miles :: Travel Time: 24 Minutes**

Take I-40 West to I-440 West. Take I-440 West to I-65 South to Exit 69 (Galleria Blvd.). This exit takes you directly to the mall. Once in the mall area, take a left and park at the "Ruby Tuesday" entrance. Go straight to the escalator, go downstairs and take a sharp right toward JCPenny. We are next to JCPenny on the right.