

NEW YORK/TARRYTOWN

560 White Plains Road
Suite 330

Tarrytown, NY 10591

Tel: 914.631.1019 Fax: 914.631.0759

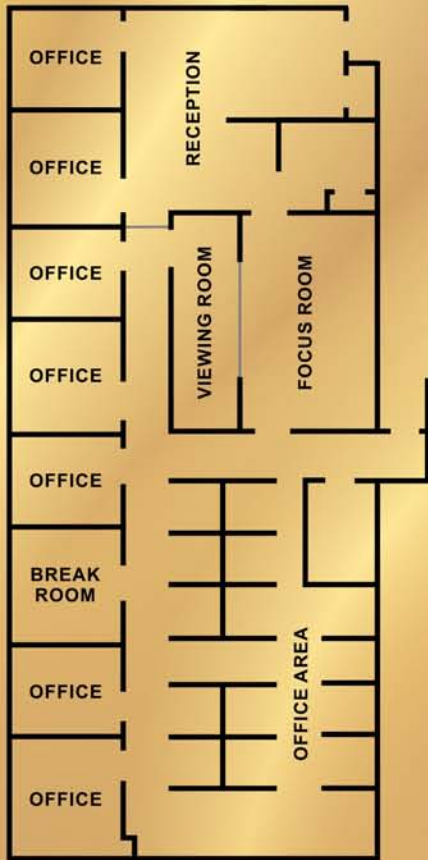

CRG GLOBAL, INC.

www.crgglobalinc.com



Hotel Recommendations

Doubletree Hotel of Tarrytown: 914.631.5700
Marriott Hotel Westchester: 800.882.1042

Area Restaurants

Equus Rest Castle Tarrytown: 914.631.3646
La Piazza: 914.631.4484

Demographics

Average Age: 34
Average Income: \$55,000
Ethnic Mix:
% Caucasian 85
% African American 5
% Hispanic 5
% Other 5

Minimum PC Setup

2.4 Ghz, 256 MB RAM,
40 GB HD, Intel Extreme Graphics

In-Depth Interviewing

Executive/Professional
Medical

Facility Description

Interview Rooms: 7
Size: 14x20
Focus Room Seats: 15
Size: 14x8
Viewing Room Seats: 6

Test Kitchen Equipment

Refrigerators 1
Microwaves 1
Freezers 1
Double Ovens 0
Range Top Ovens 0
Electric Burners 0

Interviewing Stations: 0

Services Offered

Mall Intercept CAPI / Web
In-Store / Audits Pre-Recruits
Offsite CLT Interviewing
Panel Recruitment

Recruiting Via

Online Automated Recruitment
(Recruiting can be done on site or centrally at corporate using services of Powerdial, CRG's 30 seat telephone center.)

Directions:

From Newark Liberty Intl. Airport :: Distance: 41 Miles :: Travel Time: 52 Minutes

Merge onto I-78 Express E toward Holland Tunnel/ I-95/ NJ Turnpike/ NY City. Take the NJ Turnpike N/ I-95 N exit. Keep North toward exits 15W - 18W/ I-280/ G. Washington Br/ RT-3/ Meadowlands Complex. Take I-95 N/ NJ Turnpike N toward Ft. Lee/ G Washington Br/ US-46. Take I-95 N toward GW Br. Upper Level/ US-1 N/ US-9 N (Crossing into NY). Take the I-87 exit, EXIT 1C, toward Maj. Deegan Expwy/ Albany/Queens. Merge onto I-87 N via exit 3N toward Albany. Take I-287 E exit 8 toward Cross Westchester Expwy/White Plains. Take exit toward RT-119/ Saw Mill Pkwy N. Take the RT-119 exit toward Elmsford. Turn Right onto W Main St/ NY-119/ Tarrytown-White Plains Rd. End at 560 White Plains Rd Tarrytown.

Directions:

From LaGuardia Intl. Airport :: Distance: 26 Miles :: Travel Time: 37 Minutes

Start out going West on 23RD Ave toward 89TH St. Turn right onto 82ND St. 82ND St. becomes Ditmars Blvd. Turn left onto Astoria Blvd N/ Grand Ctrl Pkwy. Follow Astoria Blvd. N. Merge onto Grand Central Pkwy W toward Triboro Br. Grand Central Pkwy W becomes I-278 E. Merge onto I-87 N via exit 47 on the left toward Albany. Take the I-287 E exit 8 toward Cross Westchester Expwy/ White Plains. Take the exit toward RT-119/ Saw Mill Pkwy N. Take the RT-119 exit toward Elmsford. Turn right onto W Main St/ NY-119/ Tarrytown-White Plains Rd. Follow NY-119/ Tarrytown-White Plains RD.