

# PORTLAND

Lloyd Center Mall

906 Lloyd Center

Suite B 1108

Portland, OR 97232

Tel: 503.287.7812 Fax: 503.287.7843

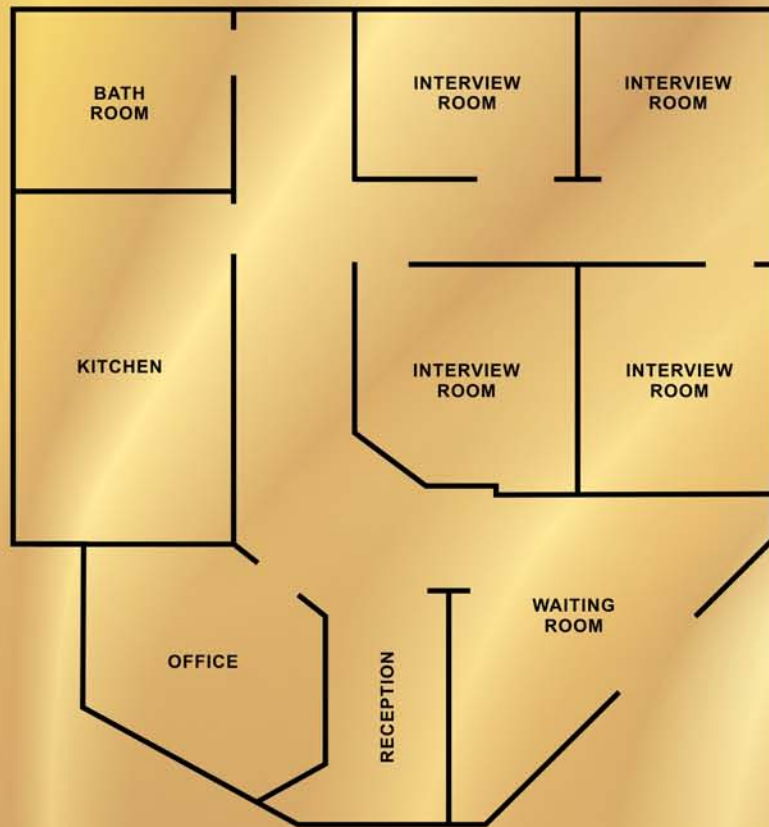

CRG GLOBAL, INC.

www.crgglobalinc.com



## Hotel Recommendations

Doubletree Lloyd Center: 503.281.6111

Hilton Portland: 503.226.1611

## Area Restaurants

Heathman Restaurant: 503.790.7752

Ruth Chris Steakhouse: 503.221.4518

## Demographics

Average Age: 35

Average Income: \$59,038

Ethnic Mix:

% Caucasian 84

% African American 5

% Hispanic 4

% Other 7

## Anchor Stores

Marshalls, Sears, Ross, Nordstrom,  
Barnes & Noble, Cinema's

## Minimum PC Setup

2.4 Ghz, 256 MB RAM,  
40 GB HD, Intel Extreme Graphics

## In-Depth Interviewing

Executive/Professional  
Medical

## Facility Description

Interview Rooms: 4

Size: N/A

Focus Room Seats: N/A

Size: N/A

Viewing Room Seats: N/A

## Test Kitchen Equipment

Refrigerators 1

Microwaves 1

Freezers 0

Double Ovens 0

Range Top Ovens 0

Electric Burners 2

Interviewing Stations: 5

## Services Offered

Mall Intercept CAPI / Web  
In-Store / Audits Pre-Recruits  
Offsite CLT Interviewing  
Panel Recruitment

## Recruiting Via

Online Automated Recruitment  
(Recruiting can be done on site or  
centrally at corporate using  
services of Powerdial, CRG's 30  
seat telephone center.)

## Directions:

From Portland International Airport :: Distance: 11 Miles :: Travel Time: 17 Minutes

Take I-205 South to I-84. Stay on I-84 until exit 1 (Lloyd Boulevard) and stay to the right. Lloyd Center will be straight ahead on 13th and Multnomah.